

Concerned Citizen and Life School Stakeholder:

BIG CITY CRUSHED CONCRETE COMPANY is applying for a permit to process concrete removed from demolished buildings and other sources. It is the opinion of Life School Administration and Board members that the concrete crushing plant **will threaten the safety and health** of persons in close proximity to the plant. **Air quality will be affected** and the **noise of heavy machinery** will be disruptive to the learning processes of Life School students.

Over 2,000 vehicles a day enter and exit the **Oaks Fellowship/Life School Red Oak** campus from 6:00 AM-6:00 PM. The **school has over 1,000 students** dropped off and picked up daily, and more than **5,000 church constituents** that require access to the facilities. Six days a week, **two police officers** are hired to **direct traffic at the intersections** of the I-35 bridge, the north and south service roads and the Oaks Boulevard. The routing of the large trucks transporting slabs and chunks of discarded concrete will **overwhelm the transportation infrastructure** on both sides of the bridge and the entrances to the school and church.

The heavily loaded trucks will **endanger other vehicular traffic** and cause **traffic congestion** that will **clog the transportation infrastructure** that is in place.

As a stakeholder of Life School, I am asking you to protest the approval of the **BIG CITY CRUSHED CONCRETE COMPANY** on the proposed property, across the Oaks Boulevard to the south as shown on the enclosed map.

Please fill in the blanks on the protest form provided and mail it by 08/29:

The City of Waxahachie Planning and Zoning Commission
401 S. Rogers
Waxahachie, TX 75168

Suggested **Bullet Points** in your written reasons protesting approval of this plant:

(Identify yourself as a **STAKEHOLDER** of Life School. Provide personal information requested.)

- Plant threatens health/safety of our children
- Noisy machinery/truck traffic disrupt student's learning process
- Trucks on the bridge/service roads + 2,000 vehicles entering/exiting daily = traffic accidents more numerous and severe.
- Concrete trucks will clog normal traffic flow by using the only approach available: the bridge and the service road. Police officers are hired six days a week to direct traffic presently. Impassable traffic jams will certainly result if this plant opens.
- The plant is a threat to the environment and air quality of a public school.

For our Children,

Tom Wilson, Ph.D.
Chancellor of Life School

400 0 400 800 Feet

ZA2010-11

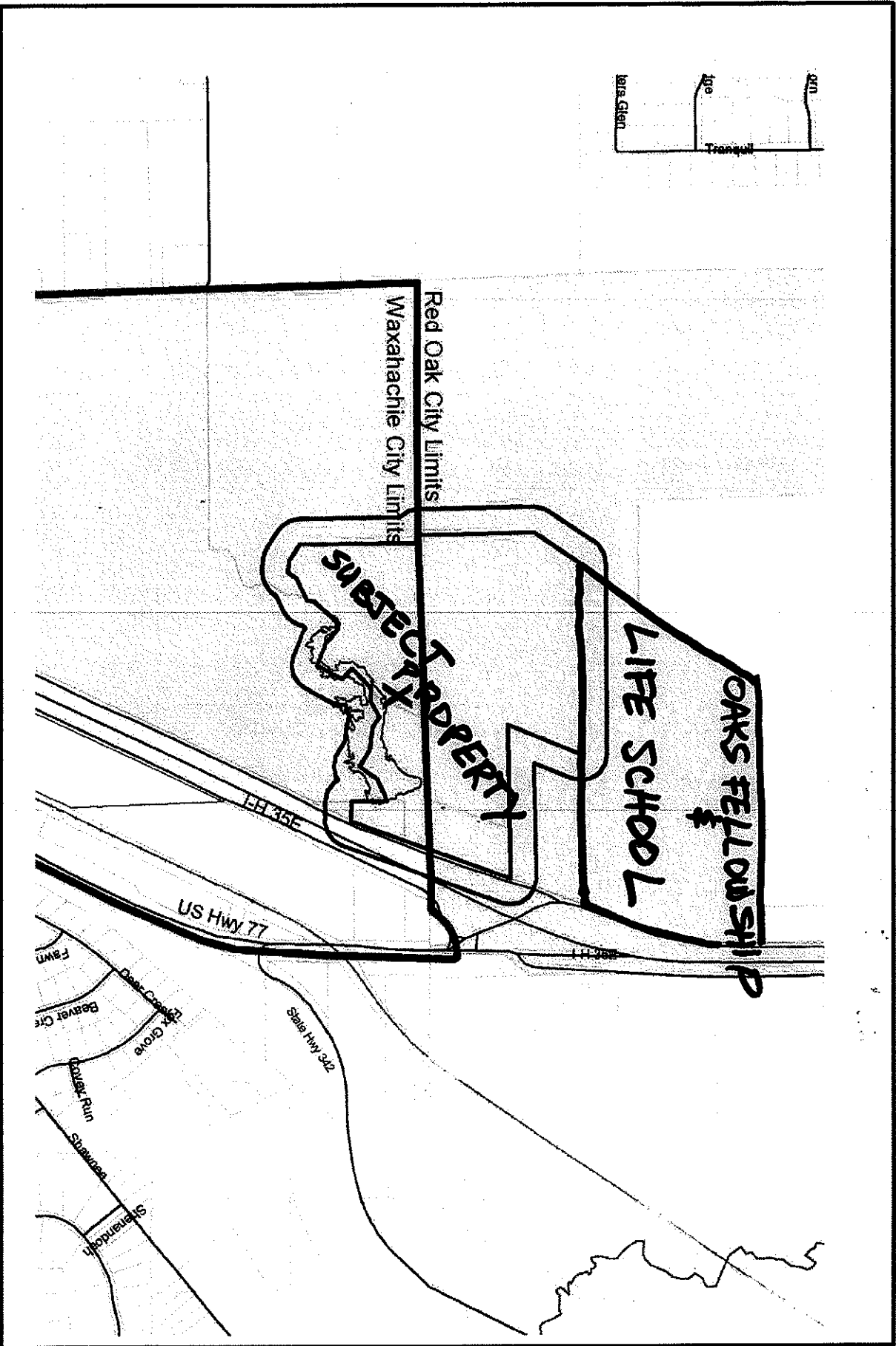

The City Council will hold a Public Hearing
on this request MONDAY, 09/20/10
at 7:00 p.m. in the Council Chamber, 401 S. Rogers

ZONING AMENDMENT REQUEST NO. 2010-11
Date: August 27, 2010

**CITY OF WAXAHACHIE, TEXAS NOTICE OF APPLICATION
FOR REQUEST FOR ZONING CHANGE**

A REQUEST HAS BEEN RECEIVED FROM: Big City Crushed Concrete
(Applicant)

TO CHANGE THE ZONING ON: LOT _____, BLOCK _____

ADDITION OR SURVEY: James Lawrence, Abst. 633; James McKnight, Abst. 733; Albert Fredrick, Abst. 375

ADDRESS: IH 35 North

OTHER DESCRIPTION: 29.60 acres

FROM: Light Industrial and Future Development (LI and FD)

TO: Light Industrial with a Specific Use Permit (LI w/SUP)

PROPOSED USE OF PROPERTY IF ZONING IS APPROVED: Concrete recycling and storage facility

**THE PLANNING & ZONING COMMISSION OF THE CITY OF WAXAHACHIE, TEXAS WILL HOLD A
PUBLIC HEARING PURSUANT TO THE REQUEST ON:**

September 8, 2010 AT 4:30 p.m.
(date) (time)

City of Waxahachie Council Chambers at 401 S. Rogers Waxahachie, TX 75165
(place)

**AS AN INTERESTED PROPERTY OWNER YOU ARE REQUESTED TO MAKE YOUR VIEWS KNOWN BY
ATTENDING THIS HEARING. IF YOU CANNOT ATTEND THE HEARING, IT IS REQUESTED THAT YOU
EXPRESS YOUR VIEWS ON THIS REQUEST BY FILLING IN AND RETURNING THE BOTTOM PORTION OF
THIS NOTICE. (PLEASE SEE ATTACHED SECTION 10.8(E) OF THE ZONING ORDINANCE FOR
ADDITIONAL INFORMATION.)**

(Please detach here and return to: City Secretary, P.O. Box 757, Waxahachie, Texas 75168)

Zoning Amendment Request No: 2010-11
Date: August 27, 2010

AS AN INTERESTED PROPERTY OWNER I (PROTEST), (APPROVE) THE REQUESTED ZONING CHANGE.

(Please give reasons for your protest or approval)

ZONING AMENDMENT REQUEST NO. 2010-11
Request by Big City Crushed Concrete, for a Zoning Amendment from Light Industrial and Future Development (LI and FD) to Light Industrial with a Specific Use Permit (LI w/SUP) for a concrete recycling and storage facility which could create a problem to the environment to be located on IH35 North, being 29.60 acres of the James Lawrence Survey, Abstract No. 633, James McKnight Survey, Abstract No. 733, and Albert Fredrick Survey, Abstract No. 375- Owners: Palm Harbor (Jim Sargent)

Printed Name: _____

Signed: _____

Address: _____

Date: _____

